



SHOP R05

(Lot S34a), 114 Adderley Street, West Melbourne 3003

FOR SALE
\$1,563,000

Area: 172sqm

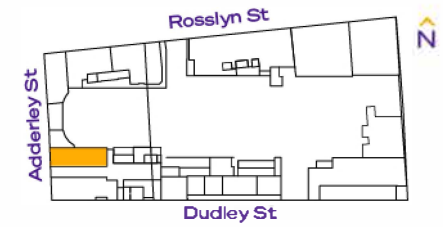
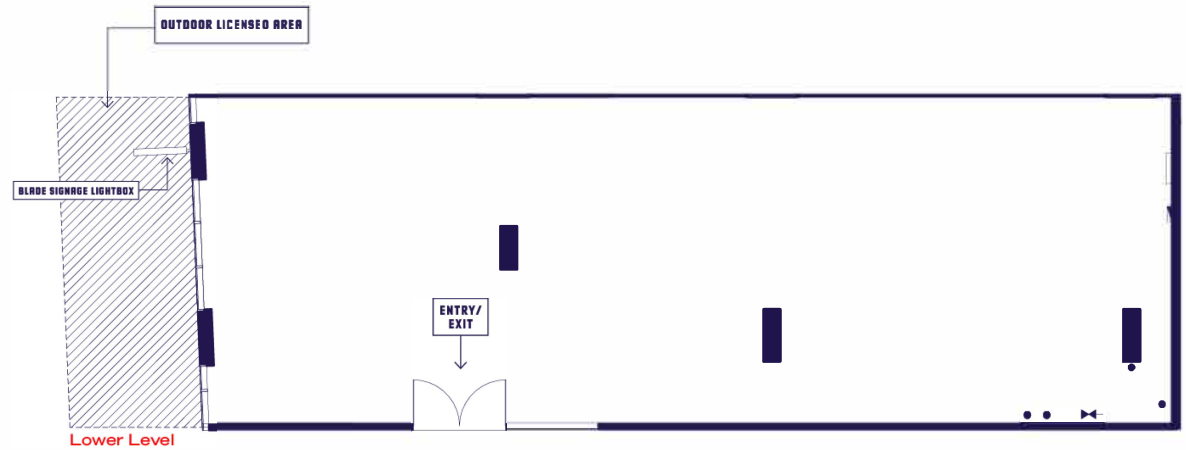

COMMERCIAL SPACE FOR SALE

CURRENT LEASE STATUS

Tenanted

Base rent: \$81,700 per annum

Rent Guarantee term: 5 years

Rent Guarantee amount: \$81,700 per annum

Tenant: GingerSnap	Tenant: GingerSnap / West End Landco	
Sale	Lease Expiry: 31 Dec 2024	5 years

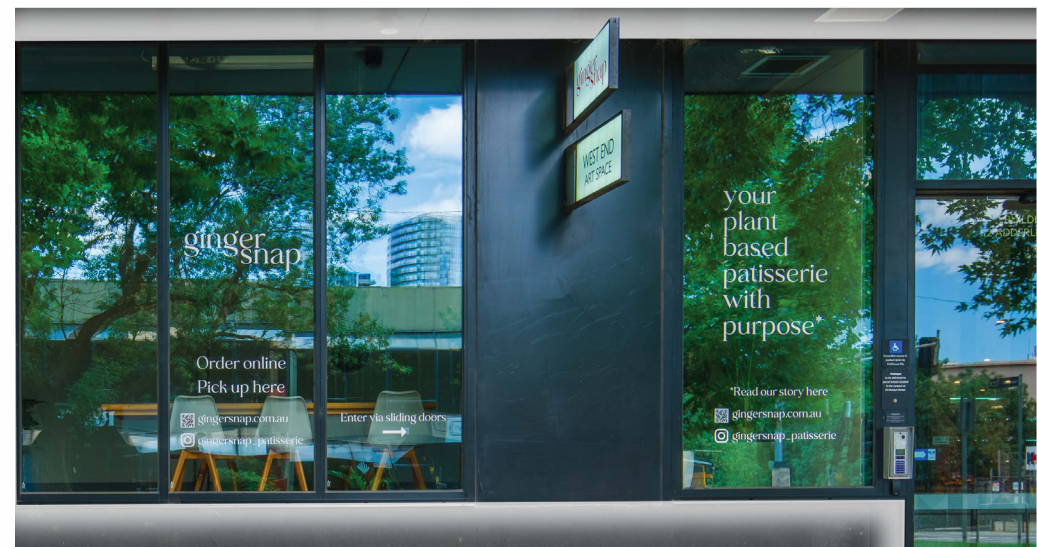

Existing tenant: GingerSnap

This family run patisserie has moved from a thriving online-only business selling high-end plant based desserts. The pastry chef has come from Crown Melbourne and is profoundly deaf, sparking the business to be an emblem of inclusivity by hiring staff with disabilities. They are also now expanding to include wholesale.

COMMERCIAL SPACE FOR SALE